



CITY OF TOLEDO PLANNING DEPARTMENT

- EXCAVATION/FILL PERMIT APPLICATION
WORK IN THE RIGHT-OF-WAY PERMIT

Date 6/30/21 Permit Number

Property Address ROW Near 620 W Hwy 20, Toledo, OR Zone Designation
Assessor's Map No. 11-10-07DD Tax Lot No. Lot Size sq. ft.

Property Owner(s) City of Toledo Phone 541-336-2247
Address PO Box 220, Toledo, OR 97391

Applicant's Name Port of Toledo Phone 541-336-5207
Address PO Box 428, Toledo, OR 97391

Contractor No. To Be Determined Expiration Date Toledo Business Lic. No.

Location of work to be performed Along City sewer line @ intersection of Hwy 20 and NW Bay Road

Describe work to be performed Bore/trench across Hwy 20, excavate-install new manhole & connect to sewer

- 1. Is this application associated with an existing land use or building permit application? Yes X No
If yes, permit #FP1-21
2. Is an excavation/fill permit needed by Corps of Engineers/DSL? Yes No X
3. Will the work take place in the public right-of-way? Yes X No
If yes, will the work take place on Business Highway 20 or a designated truck route? Yes X No
4. Is an engineer review required? Yes No
If yes, has an engineer approved plan been submitted? Yes X No
5. If fill is removed, will it be located on a site that requires a Fill Permit? Yes No X
If yes, where will fill material be located?

The following information is required with this application (2 copies of each drawn to scale):

- A. A Site Plan with the existing contours, proposed contours, cutting areas, filling areas, defined and showing property lines and corner location (recorded survey if available).
B. Include location and construction drawings for any retaining walls.
C. Include profiles of any proposed cuts or fills.
D. Include drainage plans showing impervious surfaces, direction of flow, any proposed containment, facilities/areas and connection to the nearest public storm drainage system.
E. Include a specific erosion control program and time line.

CALL BEFORE YOU DIG (1-800-332-2344): Oregon law requires you to follow rules adopted by the Oregon Utility Notification Center. Those rules are set forth in OAR952-001-0010 through OAR952-001-0090. You may obtain copies of the rules by calling the Oregon Utility Notification Center at (503) 232-1987 or at the City of Toledo Public Works Department. Note: OAR Chapter 952 is in reference to underground utility requirements.

As part of this application, I agree to pay to the City of Toledo all costs, including a 20% charge for administrative overhead, incurred for repair work performed by the City as a result of damage and/or clean-up by applicant's work to public right-of-way surfaces or city utilities or other facilities. I agree to comply with all requirements as stated in Chapter 70 of the Uniform Building Code. I further agree to comply with the requirements for the replacement of signs and barricades and for other safety measures set forth in the Manual for Uniform Traffic Control Devices. I further agree to defend, indemnify, and hold harmless the City of Toledo, its officers, agents, and employees from any and all claims for injuries to persons and damage to property arising out of the work performed under this permit.

Applicant signature line

Date 6/30/21

**\*\*Office Use Only\*\***

**EXCAVATION/FILL PERMIT CHECKLIST  
DEPARTMENT REVIEW**

- 1. Will the work take place in the public right-of-way?      Yes   X        No
- 2. Is an engineer review required?      Yes           No   X
- 3. Has an engineer approved the plan received?      Yes   X        No
- 4. Is a City inspection required for the excavation/backfilling?      Yes   X        No

Comments City Inspector to view backfill & compaction procedures.  
Compaction testing Required as per City standards due to Truck Route. Repair within 5 workdays (weather permitting)

Grading Permit Fees \$ \_\_\_\_\_  
Right-of-Way Permit Fee   \$40.00  

Plan Review Fees \$ \_\_\_\_\_

**REVIEWED AND APPROVED BY:**

  *Paul Zuppan*    
Public Works Director

  7-8-21    
Date

\_\_\_\_\_  
Community Development Coordinator

\_\_\_\_\_  
Date

**Grading Permit Fee\***

Up to 100 cubic yards .....	\$50.00
101 to 1,000 cubic yards .....	\$50.00 for the first 100 cubic yards, plus \$15.00 for each additional 100 cubic yards or fraction thereof
1,001 to 10,000 cubic yards .....	\$185.00 for the first 1,000 cubic yards, plus \$13.00 for each additional 1,000 cubic yards or fraction thereof
10,001 to 100,000 cubic yards .....	\$302.00 for the first 10,000 cubic yards, plus \$50.00 for each additional 10,000 cubic yards or fraction thereof
100,001 cubic yards or more .....	\$752.00 for the first 100,000 cubic yards, plus \$30.00 for each additional 10,000 cubic yards or fraction thereof

\* The fee for a grading permit authorizing additional work to that under a valid permit shall be the difference between the fee paid for the original permit and the fee shown for the entire project.

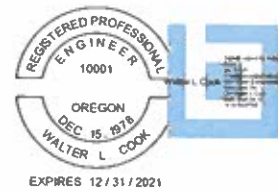
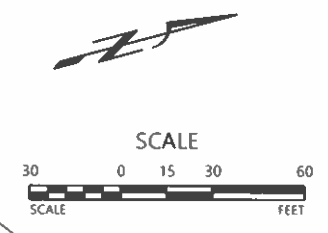
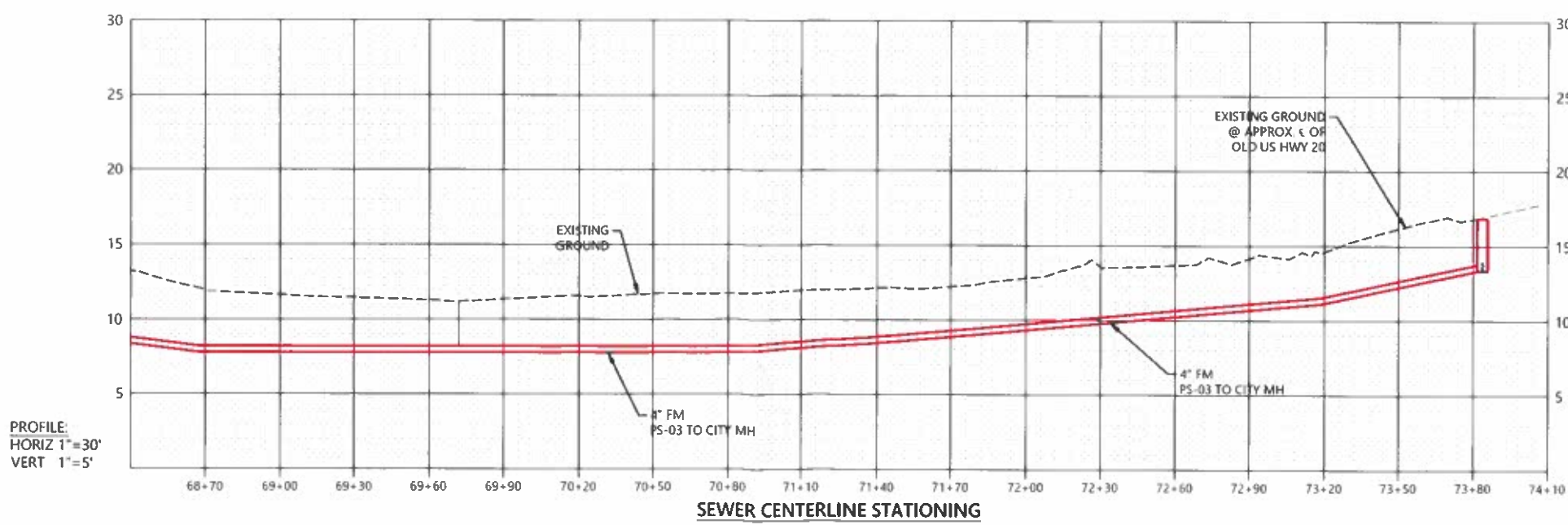
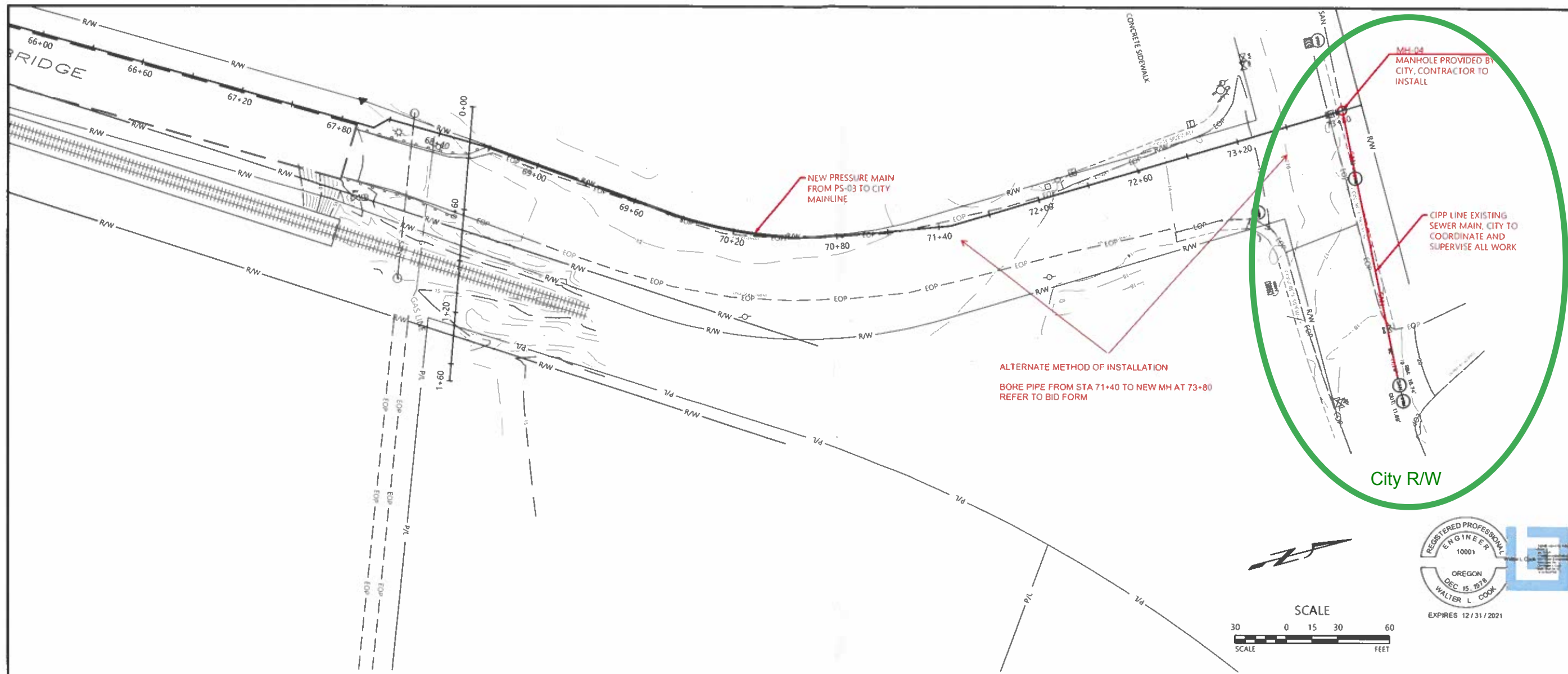

NO.	DATE	REVISIONS

**PORT OF TOLEDO**  
 PROJECT SITE:  
 496 NE HWY 20, UNIT 1,  
 TOLEDO, OR 97123

**SHIPYARD - SANITARY SEWER PROJECT**

**FORCE MAIN PLAN**

**WER**  
 Water Environment Resources Inc.  
 13467 SW SUMMERWOOD DR.  
 TIGARD, OR 97223  
 (503)-333-3470  
 WALTER L. COOK P.E.

DATE: 6/28/2021  
 SCALE: 1" = 30'  
 PROJ. NO.: 1001  
 DRAWN BY: MAJ  
 CHECKED BY: MLC  
 SHEET NO:

**CITY/COUNTY PERMIT SET**  
**6/28/2021**

**S06**  
 9 OF 16

P1\_PP1.dwg